



**TRAXEED**  
KÖRBER SOLUTIONS

## SingleUnit-Basic

The Traxeed SingleUnit-Basic is a compact solution for coding and verification of single cartons for the installation into the product packaging process of pharmaceutical industry.

This Traxeed Track&Trace Solution is modularly designed and meets a wide range of customer requirements. It combines product transport with printing, vision control, reject system and batch controller. Configurable software features ensure that the system complies with track and trace regulations worldwide.



### FEATURES

#### Conveyor system

- Servo driven top/bottom conveyor belt with adjustable guiding
- Belt speed adjustable up to 90 m/min
- Transfer height variable from 850 to 950 mm
- Optional speed controlled infeed and outfeed conveyor belts

#### Machine cover

- Coloured housing to remove effects of external light
- Optional clear transparent cover
- Optional proximity / lockable door safety switch

#### Coding system

- Thermal inkjet printer Wolke m610 advanced/oem
- Resolution: 300 dpi
- Coding speed up to 60 m/min
- Print height 12.7 mm per print head
- Up to 4 print heads to print in up to two locations simultaneously or to increase print height to 25.4 mm (max. 2 print heads on one side)

#### Inspection system

- Traxeed vision system including camera station and LED lighting
- b/w CCD-Matrix-Camera
- Field of view w = 60 mm, h = 40 mm
- Resolution: 1296 x 966 pixel
- Optional additional camera station to verify data in two different positions simultaneously

## FEATURES

### Reject station

- Pneumatic driven air blower
- Compressed air consumption at continuous operation: approx. 90 Nm<sup>3</sup>/h
- Reject verification with light barrier
- Rejected products are collected in a reject bin

### Industrial PC

- B&R Industrial PC
- CPU Intel Core i7
- RAM 4 GB DDR3
- SSD 60 GB
- 15" TFT Touch Screen

### Installation requirements

- Voltage: 230 V, 50 Hz (L, N, PE)
- Power: ca. 1.5 kW
- Pneumatics: 6 bar clean dry air

### Operating Conditions

- Temperature: 10°C – 40°C
- Humidity: 0% – 80% RH (non-condensing)

## SPECIFICATIONS

### Product dimensions

	min.	max.
Width (W)	30 mm	160 mm
Height (H)	15 mm	105 mm
Length (L)	60 mm	220 mm
Weight	30 g	150 g

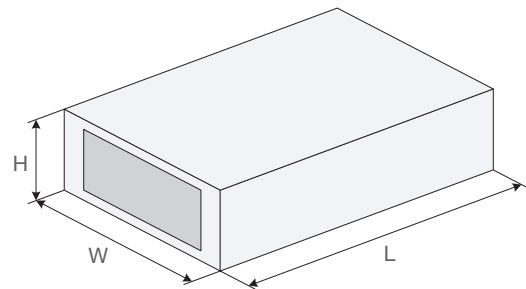

### Sample print layout

- A Barcode size
- B Code field length
- D Line space
- L Text length
- H Text height
- Q Quiet zone

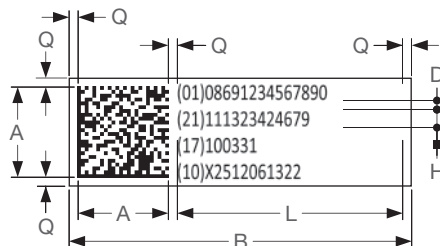

### Print positions

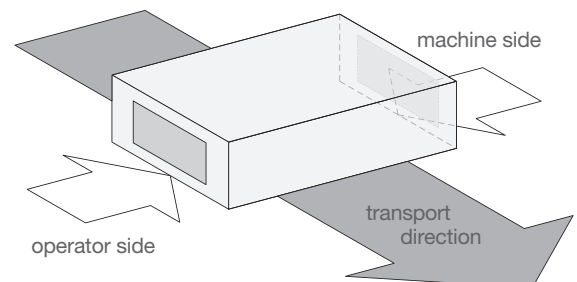

### Conveyor system

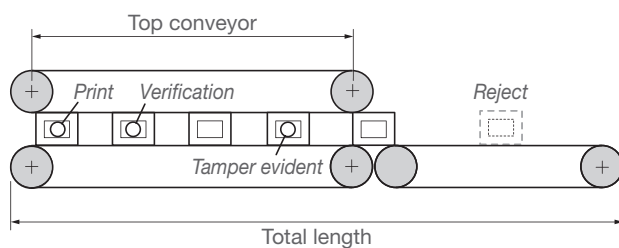

**DIMENSIONS**

**Space requirements:**

- Total length: 897 mm
- Total depth: 1322 mm
- Total height: 2235 ± 50 mm

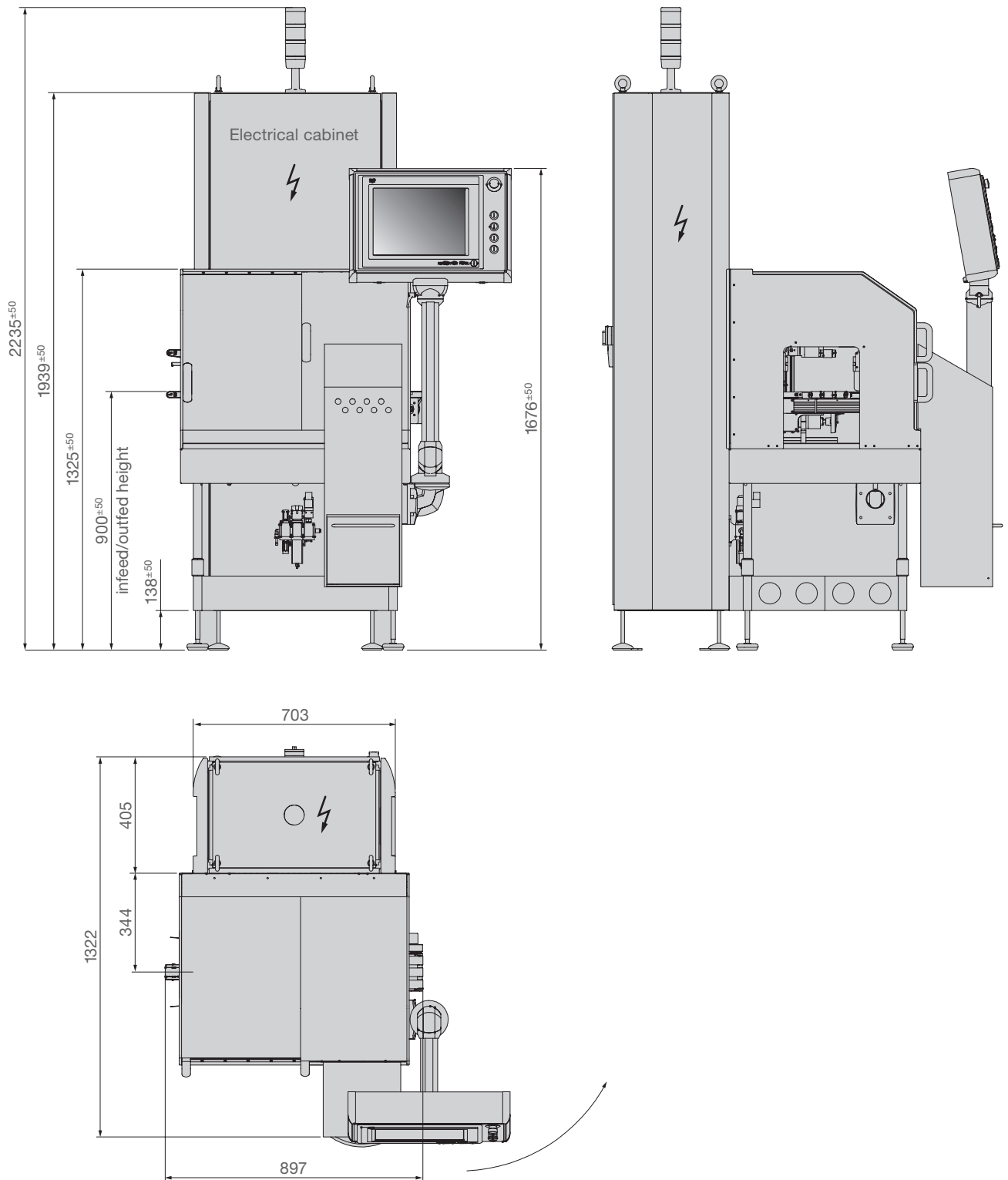

## TRAXEED LIFE CYCLE SERVICE



### **Traxeed Service Desk**

The Service Desk is staffed by qualified experts. They can provide 24/7 service 360 days a year. The Service Desk combines maximum competence with short response and solution times.



### **Traxeed Academy**

Our customized training and support programs impart theoretical and practical knowledge to enhance the productivity of your employees.



### **Traxeed Field Service**

Our technicians have the expertise and understanding that comes from time, training, dedication to their craft and determination to provide superior service to every customer.



### **Traxeed Original Spare Parts**

We stock an extensive inventory of original spare parts at our worldwide locations to ensure speedy delivery. Machine-specific spare parts packages are also offered to give you in-house stock for immediate installation.



### **Traxeed Retrofit/Upgrades**

Retrofit: For more flexibility and functionality, take advantage of the modularity and expandability of your machines and profit from consistently modern equipment. Upgrades: Improve your installed equipment and software with upgrades.



### **Traxeed Process Optimization/OEE**

Consulting and technical support to increase equipment performance, availability and reliability.